

**Breeza Fans USA Fan Worksheet**

Need help? 402-534-2015

**AIR FLOW REQUIREMENTS**

CFM REQUIRED:

STATIC PRESSURE REQUIRED:

FAN DRIVE RATIO (EXAMPLE 1.1:1):

GOVERNED ENGINE SPEED:

MAX. HP:

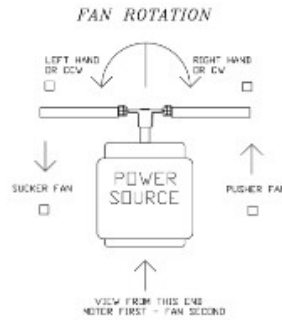

**CORRECTION FACTORS** (Skip if already corrected for )

AIR TEMPERATURE AT FAN:

ALTITUDE:

To establish rotation stand behind the power and look towards the fan. Motor first, fan second. For Gas or Diesel engines a left hand or CCW rotation is considered a sucker fan. A right hand rotating (CW) fan is referred to as a pusher fan. A sucker blows air on the power unit while a pusher draws air away from the power unit.

**FAN BLADE INFORMATION**

FAN DIAMETER:

(B) PILOT DIAMETER:

(A) BOLT CIRCLE DIAMETER:

(D) NUMBER OF BOLT HOLES:

(C) BOLT HOLE DIAMETER:

ROTATION OF FAN ie PUSHER OR SUCKER:

TIP CLEARANCE:

SHROUD TYPE:

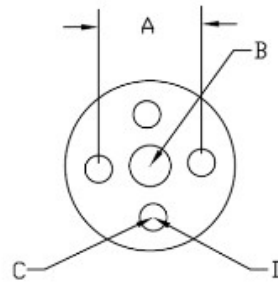

**FOR SHAFT DRIVEN FANS**

SHAFT DIAMETER:

SHAFT LENGTH:

KEY SIZE:

SET SCREW SIZE:

# OF SET SCREWS:

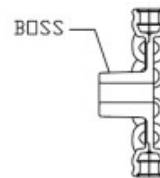

BOSS ON FAN  FACING MOTOR:  NOT FACING MOTOR:

ADDITIONAL INFORMATION:

CONTACT INFORMATION

COMPANY NAME: \_\_\_\_\_

PHONE NUMBER: \_\_\_\_\_

CONTACT PERSON: \_\_\_\_\_

EMAIL ADDRESS: \_\_\_\_\_

FAX: \_\_\_\_\_

STREET ADDRESS LINE ONE: \_\_\_\_\_

STREET ADDRESS LINE TWO: \_\_\_\_\_

CITY: \_\_\_\_\_

STATE: \_\_\_\_\_

ZIP OR POSTAL CODE: \_\_\_\_\_

COUNTRY OTHER THAN US: \_\_\_\_\_